

THIRD ANGLE PROJECTION

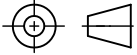

FOR GUIDANCE ONLY  
THIS INFORMATION HAS BEEN  
PROVIDED IN GOOD FAITH BUT  
SPECIFICATIONS DO CHANGE

Edition A

Date 05/11/02

Scale 1:1 @ A4

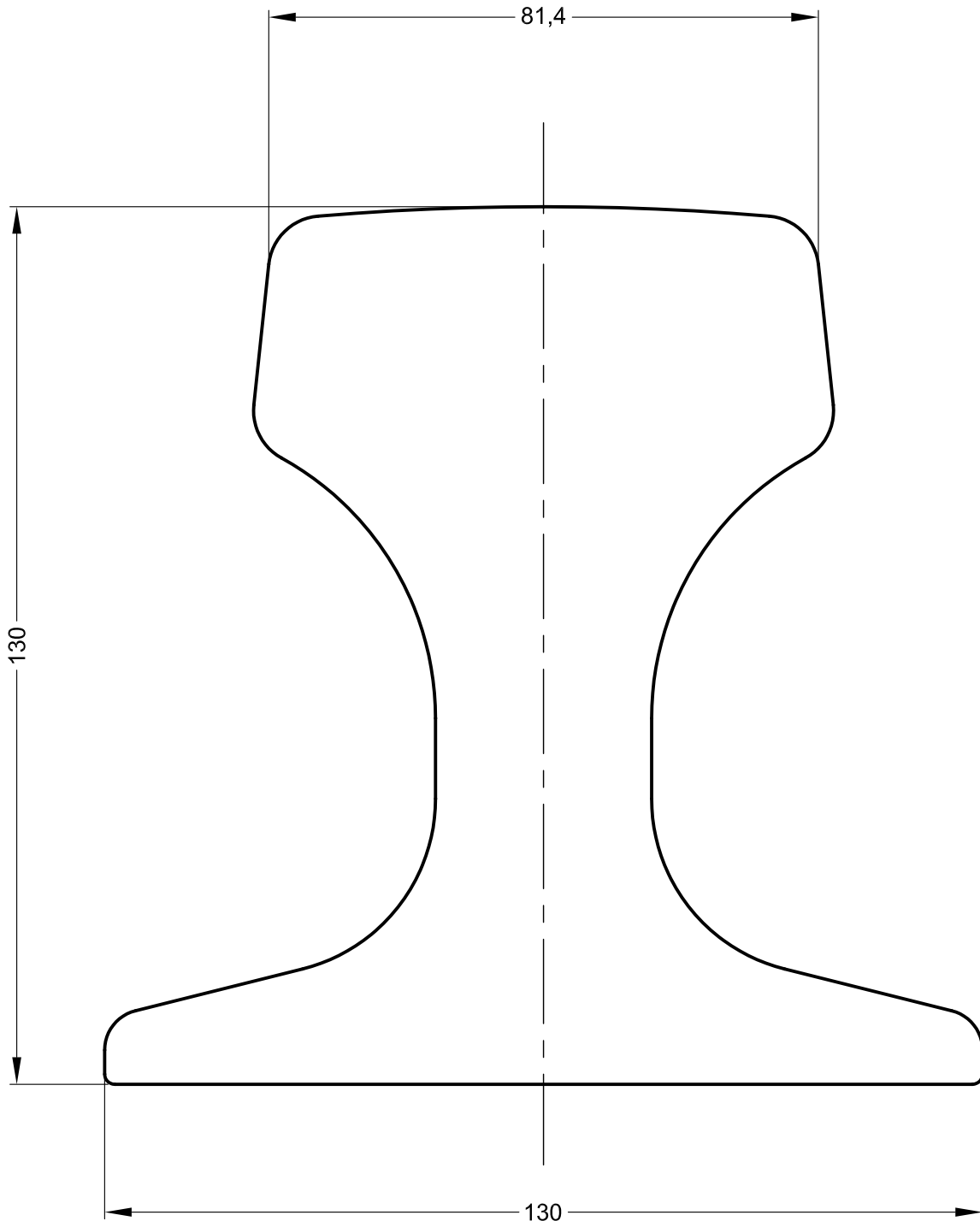

# GANTRAIL<sup>®</sup>

Rail Mounting Systems

THE TECHNICAL DATA CONTAINED IN THIS DRAWING IS THE PROPERTY  
OF GANTRY RAILING LIMITED AND IS SUBJECT TO COPYRIGHT ©

**Gantry Railing Limited**

SUDMEADOW ROAD, HEMPSTED  
GLOUCESTER GL2 5HG, ENGLAND  
Tel: (01452)300688 Fax (01452)300198  
International Dialling # 44.1452  
<http://www.gantry.co.uk>  
E-Mail: [info@gantry.co.uk](mailto:info@gantry.co.uk)

Rail Designation	QU80
Rail Origin	
Standard	
Area of section	8199 mm <sup>2</sup>
Calculated Mass	63.7 kg/m
Neutral Axis to base	64.8 mm
Moment of Inertia	I <sub>xx</sub> 1528 cm <sup>4</sup>   I <sub>yy</sub> 471 cm <sup>4</sup>